

## Model 006 Flanged Cartridge Circulator

The compact Taco 006 Flanged Cartridge Circulator is designed for circulating hot and chilled water in a wide range of closed loop applications. Its unique, field-serviceable cartridge contains all moving parts. Replacing the cartridge rebuilds the circulator. With no mechanical seal, the self-lubricating, maintenance free design provides quiet, efficient operation and unmatched reliability. Available in Cast Iron, Flanged construction. Now available with three Variable Speed control options. See Catalog# 100-24.



HYDRONIC COMPONENTS & SYSTEMS

Do it once.  
Do it right. **Taco**<sup>®</sup>

# Submission Data Information

## Model 006 Flanged Cartridge Circulator

### Features

- Standard High Capacity Output-Compact Design
- Optional Variable Speed or Priority Zoning Control
- Quiet, Efficient Operation
- Direct Drive-Low Power Consumption
- Unique Replaceable Cartridge Design-Field Serviceable
- Self Lubricating
- No Mechanical Seal
- Unmatched Reliability-Maintenance Free
- Cast Iron, Flanged Construction

### Materials of Construction

- Casing (Volute): Cast Iron  
 Stator Housing: Steel  
 Cartridge: Stainless Steel  
 Impeller: Non-Metallic  
 Shaft: Ceramic  
 Bearings: Carbon  
 O-Ring & Gaskets: EPDM

### Model Nomenclature

- F – Cast Iron, Flanged  
**Variations:**  
 Z – Zoning Circulator  
 VR – Variable Speed Outdoor Reset  
 VS – Variable Speed Set Point  
 VV – Variable Speed Variable Voltage  
 J – Bronze Cartridge with Cast Iron Casing

### Performance Data

- Flow Range: 0 – 10 GPM  
 Head Range: 0 – 9 Feet  
 Minimum Fluid Temperature: 40°F (4°C)  
 Maximum Fluid Temperature: 230°F (110°C)  
 Maximum Working Pressure: 125 psi  
 Connection Sizes: 3/4, 1", 1-1/4", 1-1/2" Flanged



**FOR INDOOR USE ONLY**

### Application

The 006 Flanged Cartridge Circulator is designed for the circulation of hot or chilled water in a wide range of closed loop applications. Typical uses include secondary hydronic heating zones, radiant heat injection, and hydro-air fan coil heating/cooling. The unique, replaceable cartridge contains all of the moving parts and allows for easy service instead of replacing the entire circulator. Available with optional Variable Speed control or Priority Zoning control with built-in transformer, relay, and priority switch in one complete package to make it ideal for zoning.

### Pump Dimensions & Weights

| Model   | A     |     | B     |     | C      |    | D       |    | F     |     | G     |     | Ship Wt. |     |
|---------|-------|-----|-------|-----|--------|----|---------|----|-------|-----|-------|-----|----------|-----|
|         | in.   | mm  | in.   | mm  | in.    | mm | in.     | mm | in.   | mm  | in.   | mm  | lbs.     | Kg  |
| 006-F4  | 6-1/4 | 159 | 4-3/8 | 111 | 3-3/16 | 78 | 2-15/16 | 75 | 4-7/8 | 124 | 6-3/8 | 162 | 7.0      | 3.2 |
| 006-ZF4 | 6-1/4 | 159 | 4-3/8 | 111 | 3-3/16 | 78 | 3-9/16  | 91 | 5-3/8 | 137 | 6-3/8 | 162 | 8.0      | 3.6 |

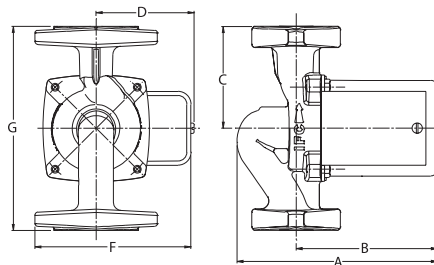

### Mounting Positions

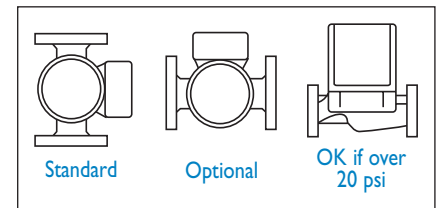

### Electrical Data

| Model          | Volts   | Hz | Ph | Amps | RPM  | HP   |
|----------------|---|----|----|------|------|------|
| 006 All Models | 115   | 60 | 1  | .52  | 3250 | 1/40 |
| Motor Type     | Permanent Split Capacitor Impedance Protected |    |    |      |      |      |
| Motor Options  | 220/50/1, 220/60/1, 230/60/1, 100/110/50/60/1 |    |    |      |      |      |

### Flange Orientation

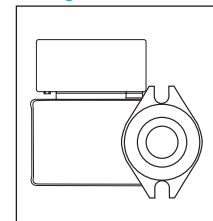

### Performance Field - 60Hz

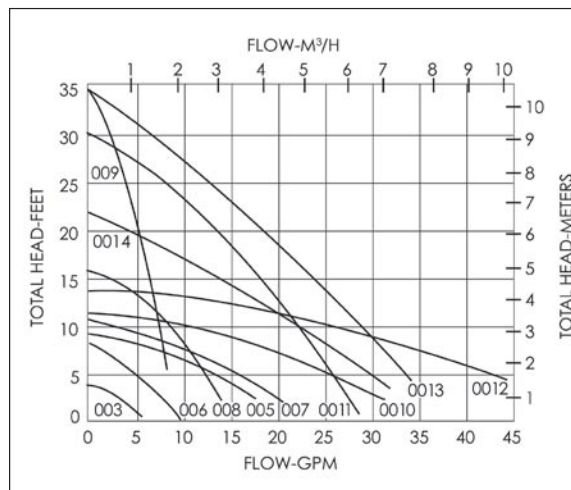

### HYDRONIC COMPONENTS & SYSTEMS

