

# Push-Tite™

## Flange Extension

Exclusive  
Feature!

This application is perfect for situations where a closet flange needs to be added, and the 4" drain pipe is well below the finished floor.

### ITEMS NEEDED:

1. Pipe saw, tape measure, screws, screwdriver, primer, glue
2. Push-Tite Gasketed Closet Flange (887-GPM, 887-GAM)
3. 3" Sch. 40 ABS/PVC pipe



## Step 1

Cut the hub of the Push-Tite, approximately 1 1/4" up from the bottom lip of the hub.

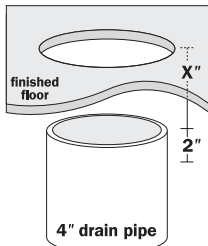

## Step 2

Measure the distance from the top of the drain pipe to the top edge of the finished floor (this distance is X), then add 2" to this measurement.

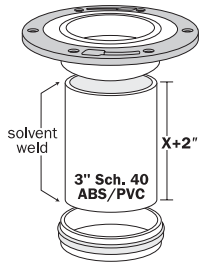

## Step 3

Cut a piece of 3" Sch. 40 pipe (X+2" long). Glue this piece of pipe between the top and bottom halves of the Push-Tite closet flange.

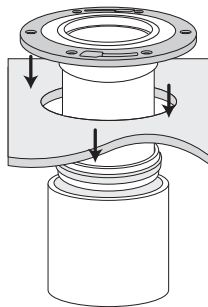

## Step 4

Lubricate the gasket (use bowl wax, silicone, stem grease, liquid soap, etc.) and push the pipe/flange assembly down into the 4" drain pipe.

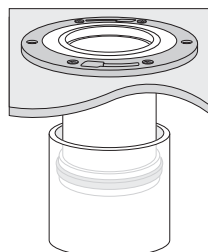

## Step 5

Secure the flange to the floor with screws and proceed with standard closet installation.

SDv1-6/03 PUSH-TITE FLANGE EXTENSION © 2003 SIOUX CHIEF MFG.



1-800-821-3944 • www.siouxchief.com

**Sioux Chief**  
MANUFACTURING COMPANY

